

# Stainless Steel Cup

## Soup Jar

### Instructions

Thank you for purchasing a "TIGER" Stainless Steel Cup.

Please read the instructions completely before use.

Keep these instructions for future reference.

#### Spoon/fork

Stored in the lid.

Collapsible, and the  
spoon/fork part can be  
changed

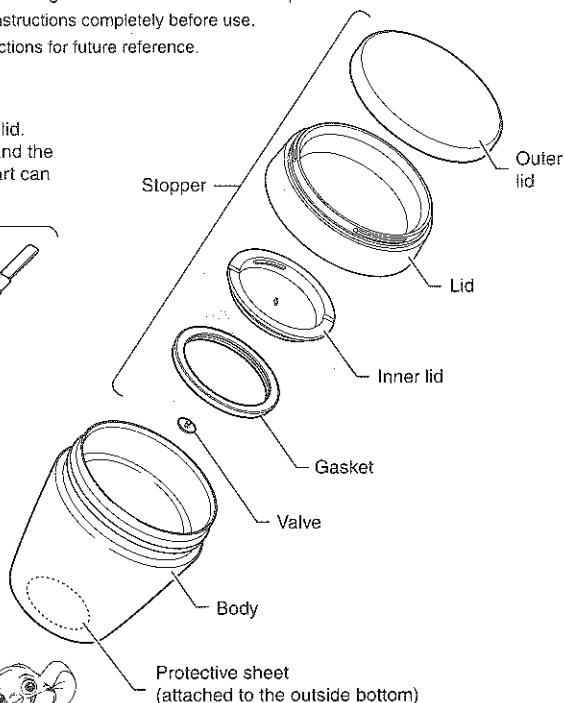
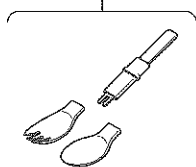

© 2003 TIGER CORPORATION

*Make sure that all parts are present before use.*

# Safety Precautions

## Important!

Keep out of reach of children.

Do not allow children to play with the product.

Do not put dry ice or carbonated beverages in the product.

Consume food that is kept inside the product as soon as possible (within 6 hours).

Clean the product immediately after use.

Do not store raw foods for a long period of time as they may spoil.

Do not place the product near stoves, open flames, or other sources of extreme heat.

Do not heat the product in a microwave oven.

Do not fill the product above the liquid capacity line shown below.

Be sure to set the stopper in proper position.

Consume foods within the day to prevent from spoiling.

Drink slowly when the product contains a hot beverage.

Noncompliance to these instructions may result in scald or injury.

Do not use the product if its ability to retain heat declines.

Hot food can make the product very hot, potentially causing burns.

Do not store foods including dairy products or cold soup without cooking them thoroughly.

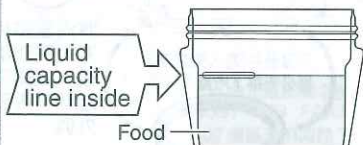

Do not use the product for any purpose other than keeping food/beverages warm or cold.

Do not knock over, drop or expose the product to excessive shocks.

Do not disassemble or attempt to repair the product by yourself.

Be sure to clean the product immediately after use, especially after consuming sports drinks.

If adding salty foods or liquids, wash immediately after consuming.

Do not use chlorine-based bleaches or acetic acid solutions when cleaning the product.

Do not remove the protective sheet on the underside of the product.

Keep the product in an upright position at all times.

Do not leave the product in a bag for a long time.

Some of the color of the contents may remain on the inner lid. This does not affect the performance and safety.

# How to Use

1

**To keep your beverage warm or cool longer.**

Pour hot (or cold) water into the body, and let it sit for one or two minutes to allow the inside of the body to heat (or cool). Discard the hot (or cold) water after preheating (or precooling).

2

**Pour hot (or cold) food into the body.**

- Do not fill the jar above the liquid capacity line shown below.

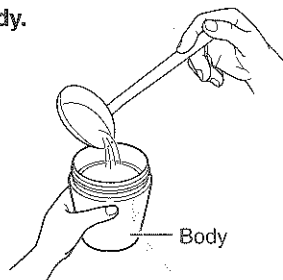
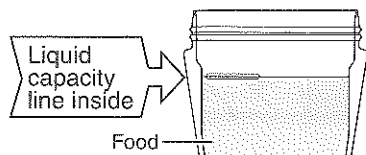

3

**Keep the product in an upright position when you close the stopper.**

- Securely close the stopper so that it cannot be turned.



4

**Open the outer lid to take out the handle and spoon or fork part, and put them together.**

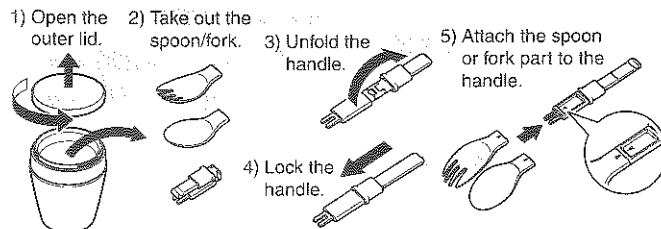

5

**Remove the stopper and enjoy your food.**

**Caution**

- Clean after every use.

6

**After use, keep the body upright and securely close the stopper. Store the spoon/fork and close the outer lid.**

**Securely close the lid and outer lid.**

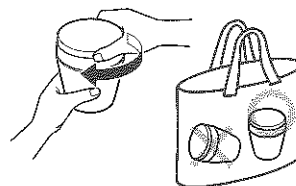

**Caution**

- Keep the product upright position all the time, even in your bag.  
Content may leak if the product is laid horizontally.



# How to Clean

- ◆ Clean after every use.
- ◆ Use mild kitchen detergent.
- ◆ Use a sponge or soft cloth.
- ◆ Be sure to clean the stopper and gasket with every use.

If odor cannot be removed from the gasket  
Odor may remain on the lid gasket depending on the contents.  
If the odor bothers you, purchase lid gaskets or stoppers for different kinds of food.  
(Example: Use separate stoppers depending on the kind of soup.)→ Back cover

## Caution

- Be sure to wipe off with dry cloth.
- Do not place the parts in a dishwasher/dryer, or in boiling water.

## Attaching and removing the inner lid

### To remove



Turn the inner lid clockwise, and pull it out lightly to remove it from the lid.

### To attach



Put the inner lid on the lid, and turn it counterclockwise to attach it.

## Attaching and removing the gasket and valve

## Caution

Attach the gasket and valve in the proper position and direction.  
If not, the contents may leak out.

### To remove



Hold the gasket and remove it slowly.

### To attach

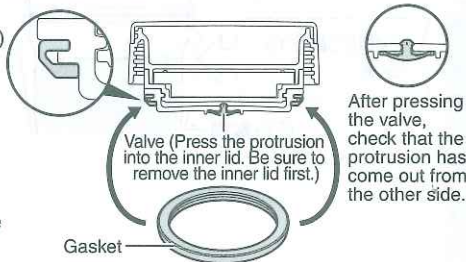

After pressing the valve, check that the protrusion has come out from the other side.

Valve (Press the protrusion into the inner lid. Be sure to remove the inner lid first.)

Gasket

When attaching the gasket, make sure to fit it completely onto the inner lid while checking the position and direction.

5

MCC-C

## Replacing and Purchasing Consumable Parts

The stopper, gasket, valve, and spoon/fork are consumable parts. Check once a year for damage/deterioration. If heavily stained or loose, replace them.

For replacement parts, contact customer service or the shop where you purchased this product.

## Before contacting customer service

The utmost measures have been taken to ensure the quality of this product. However, should the product be defective, contact your dealer and provide the following information.

1. Product name
2. Model number (printed on the label at the bottom)
3. Description of trouble (As detailed as possible)
4. Purchase date

Feel free to send any questions or comments about this product to the shop where you purchased it.

※ For the purpose of performance improvement, designs, specifications and parts shown in this publication are subject to change without notice.

## Specifications

Capacity	Liquid capacity line	Heat retention	Cold retention
0.32 liters / 10.8 oz	0.3 liters / 10.1 oz	Greater than 50°C •122°F (6hours)	Less than 12°C •54°F (6hours)
0.4 liters / 13.5 oz	0.38 liters / 12.8 oz	Greater than 55°C •131°F (6hours)	Less than 11°C •52°F (6hours)

- ※ Heat retention has been calculated under the condition of adding hot water at 95°C ±1°C • 203°F ±2°F to the bottom of the stopper and leaving it in a room temperature of 20°C ±2°C • 68°F ±4°F for 6hours.
- ※ Cold retention has been calculated under the condition of adding cold water at 4°C ±1°C • 39°F ±2°F to the bottom of the stopper and leaving it in a room temperature of 20°C ±2°C • 68°F ±4°F for 6hours.
- ※ Capacity is the actual volume of water that can be stored in the product when the stopper is closed. This is not the "Liquid capacity line" volume described in "Safety Precautions".



TIGER CORPORATION

Head Office: 3-1 Hayamicho, Kadoma City, Osaka 571-8571, Japan  
URL : <http://www.tiger.jp/global.html>

## TIGER HANBAI (H.K.) CO.,LTD.

Rm. 1006B, 10/F., Join-in Hang Sing Centre, 71 - 75 Container Port Road, Kwai Chung, N.T.

Tel: (852) 2418-0912 Fax: (852) 2418-0911

## JAPAN TIGER CORPORATION OF U.S.A.

2730 Monterey Street, Suite 105 Torrance, CA 90503

Tel: (310) 787-1985 Fax: (310) 787-1986

EMAIL: [info@japantigercorp.com](mailto:info@japantigercorp.com)